

GLASS STANDARDS

SINGLE AND INSULATED GLASS POLICY

Republic strives to produce only the best quality window products using only the finest raw materials available. We always carefully inspect our glass before and after we manufacture our products. There is no such thing as a perfect piece of glass, and there are levels of accepted flaws or “inclusions.” Our glass rigidly conforms to Federal Specifications (DD-G-451 P). If you see one of these imperfections it’s okay, your glass most likely meets industry standards.

DIRT	A small particle or foreign matter imbedded in the glass surface.
KNOT	A transparent area of incompletely assimilated glass having an irregular knotty or tangled appearance.
STONES	Any crystalline inclusion imbedded in the glass.
SCRATCH	Any marking or tearing of the surface produced in manufacturing or handling, appearing as though it were done by a sharp instrument.
GASEOUS INCLUSIONS	Bubbles at the surface of the glass which are open, leaving a cavity in the finished surface.
CRUSH	A lightly-pitted area resulting in a dull gray appearance.
DIGS	Deep, short scratches.

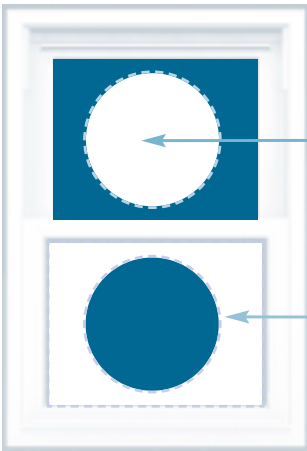

If you cannot see the flaw from the following distances, your glass meets acceptable Federal Standards.

CENTRAL VIEWING AREA
- NOT VISIBLE FROM 11 FEET

OUTER VIEWING AREA
- NOT VISIBLE FROM 20 FEET